

The reOpenTest™ COVID-19 Rapid Diagnostic Testing Solution

Features

- ✓ Affordable
- ✓ Fast Diagnostic Testing in 15 minutes
- ✓ For Non-Lab Settings Use
- ✓ Over 90% sensitivity



The reOpenTest™ COVID-19 Rapid Diagnostic Testing Solution



Top & Leading
Easy to Use

Top Performance
Easy For Non-Lab Settings Use
Point-of-Care
Online-Reports & Scan to Fill



Up to 2 Million
Daily Capacity

Made In China
No Raw Materials Limitation
Large Production Capacity
Up to 2 Million Tests / Day

*Can be Expanded to More



LMIC
Availability

Affordable
Cost as low as few dollars
Semi-Finished Solution Available



COVID-19 Rapid Diagnostic Testing Solution



Top & Leading
Easy to Use

Top Performance

- * Sensitivity > 90%;
- * Specificity > 98%;

Non-Lab Settings Use

- * Can be distribute to decentralized settings (i.e. primary healthcare, community-level care, hospital triage) ;
- * No extra equipment required, observe results with eyes directly.

Fast and Easy to Use

- * Operate in 3 steps;
- * Use Nasopharyngeal Swab;
- * View Results in 15 minutes
- * Online report or Team manage.



Up to 2 Million
Daily Capacity

Production Capacity Up to 2 Million Daily Made In China

- * Full production supporting;
- * Reliable and good material supply chains.

Semi-Finished Solution

- * Uncut-sheets available to LMIC countries;
- * Bring production to target country directly;
- * Get the most from production capacity while reducing the cost further more.



LMIC
Availability

Affordable

- * Made in China;

- * Cost can be reduced further more
- * Semi-finished solution and production in LMIC countries available.

User Instruction

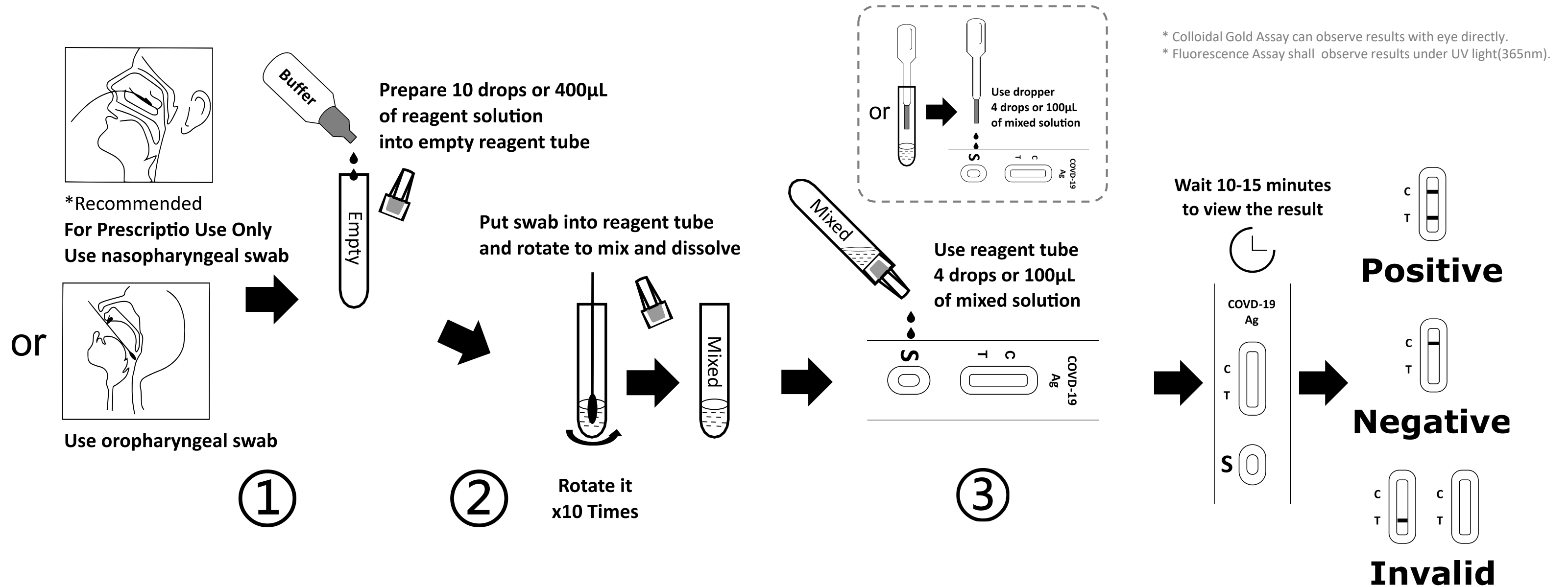



Catalogue No.:
COVG100 / COVG200

25 Test Kits Pack Contains

- ① 25x
Test Cassettes with Foil Bag Sealed.
- ② 1x
Package Insert
- ③ 25x
Nasopharyngeal Swabs
- ④ 25x
Reagent Tubes
- ⑤ 25x
Filter for Reagent Tubes
- ⑥ 1x
Buffer / Reagent Solution



①



②

⑥

④

⑤

③

reOpenTest

reOpenTest Clinical Performance

Method	PCR		Total Results
	Results		
reOpenTest™ COVID-19 Ag Test	Positive	27	29
	Negative	3	101
Total Result		30	130

Sensitivity = 90.0% (95% CI = 73.47% to 97.89%)

Specificity = 98.0% (95% CI = 92.96% to 99.76%)

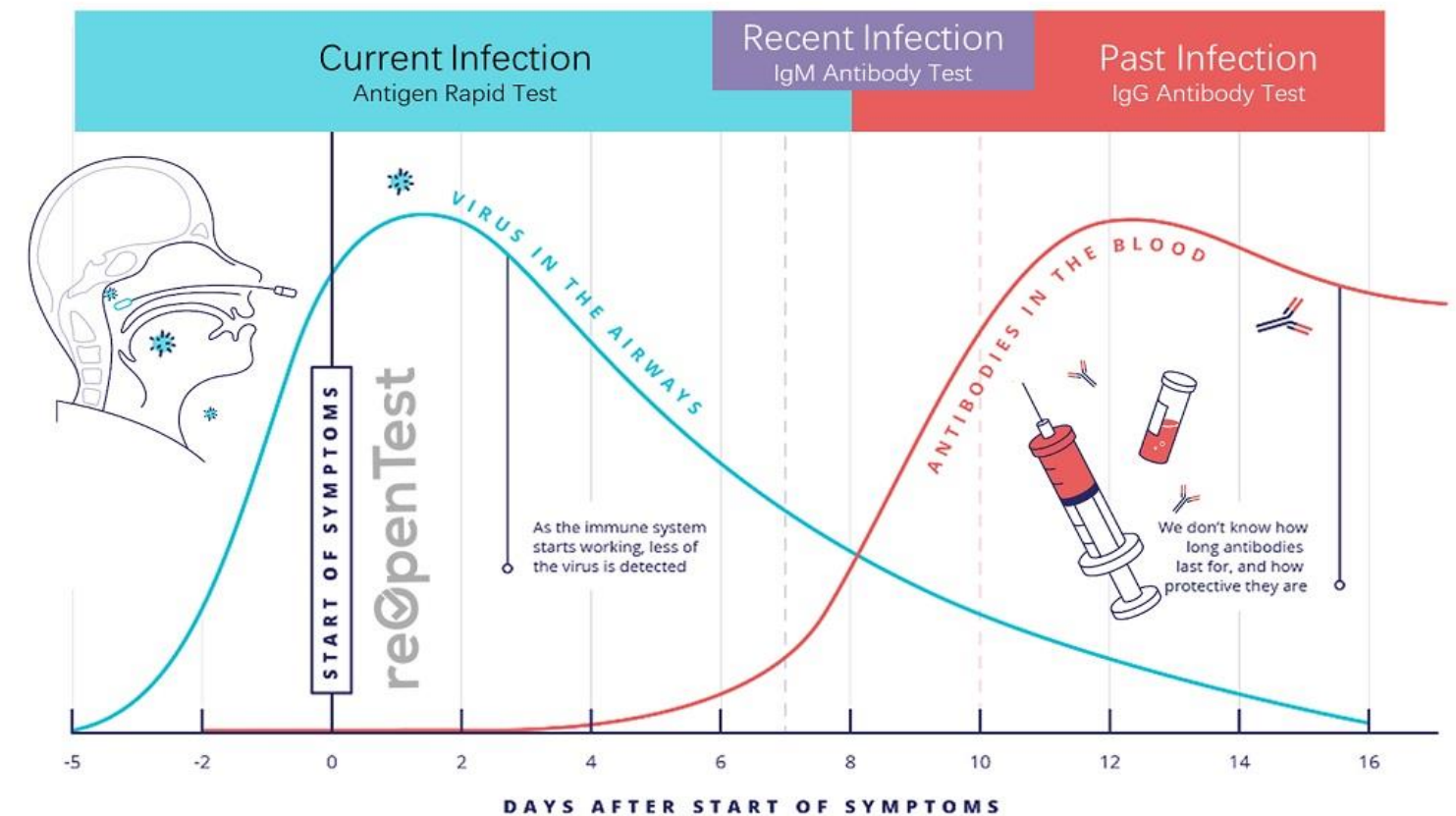

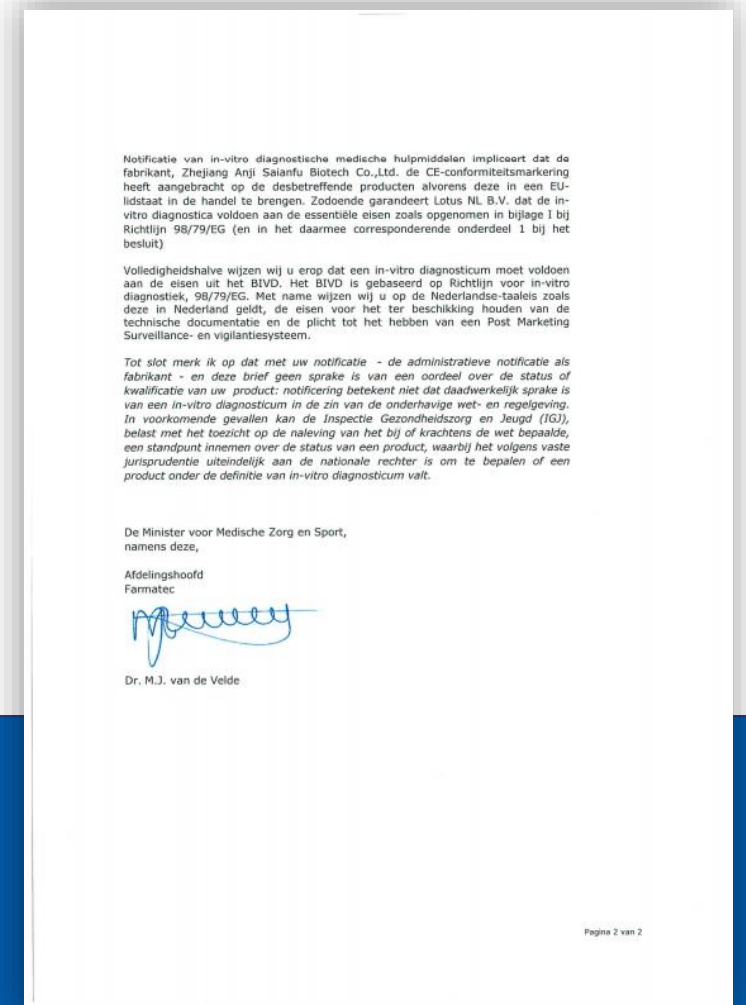
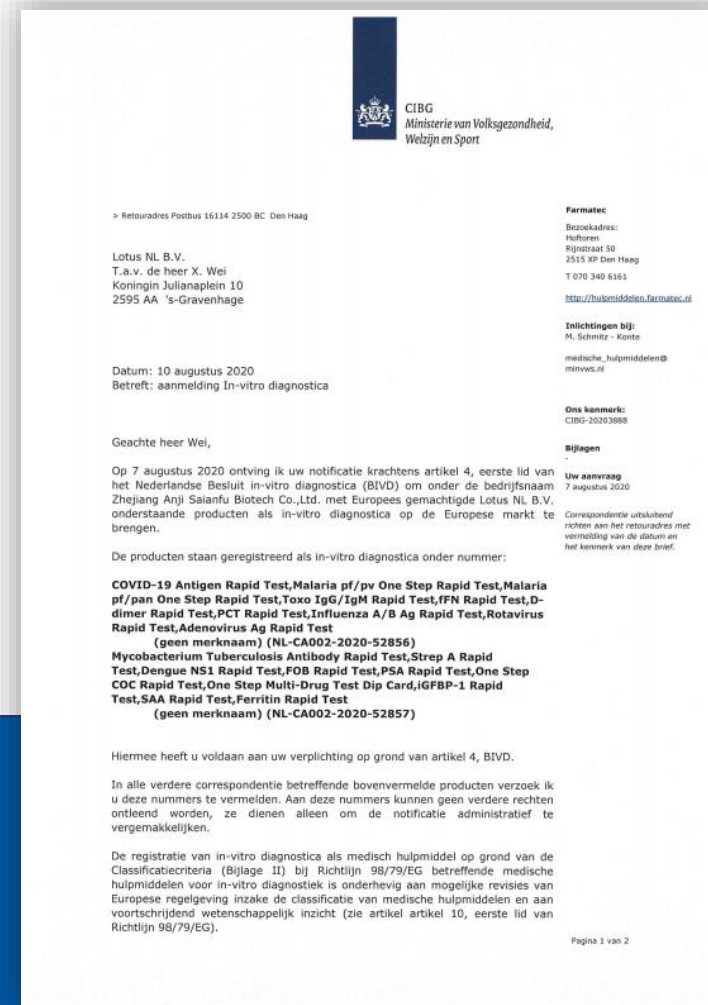
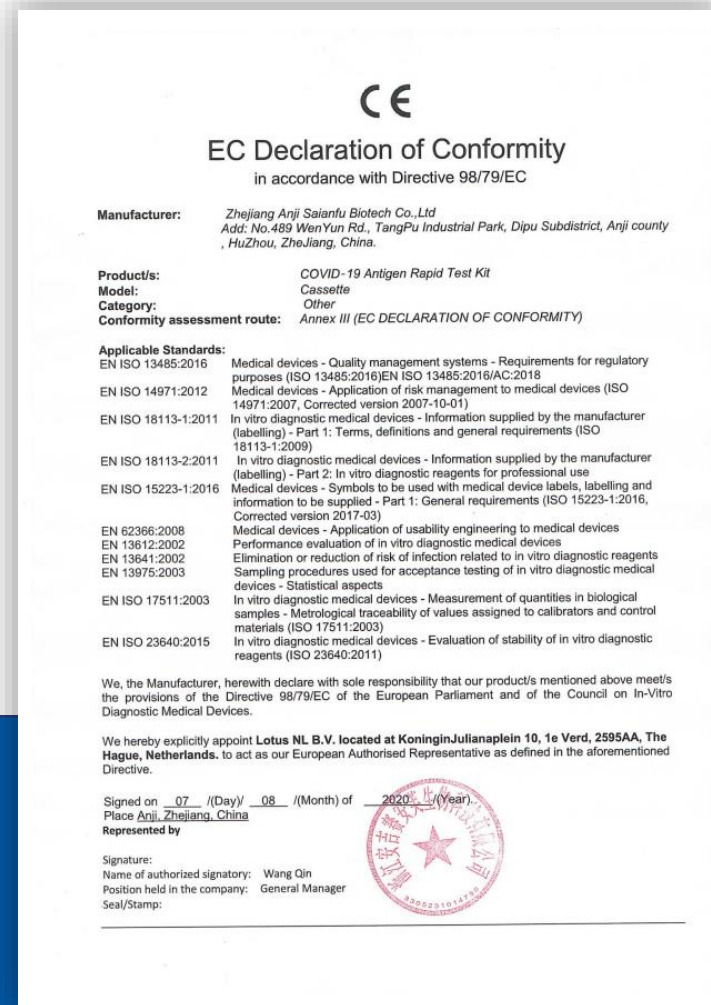

DOWNLOAD - CE/IFU/DATA/BROCHURE

Download Link: <http://www.reOpenTest.com/ifu>



reOpen Passport



Team Manage Trial
Login: <http://www.reOpenTest.com/guide/admin>
Account: demo@reopentest.com
Password: demo

Patient Trial Scan to Test



Contains: 25 Test Cassettes
25 Reagent Tubes
1 Reagent Solution

LOT 202009002

©2020 reOpenTest

1 Package Insert
25 Swabs

202203

reOpenTest

reOpenTest COVID-19 Ag

COVID-19 Ag Buffer
LOT: 202009
EXP: 202208
10ml



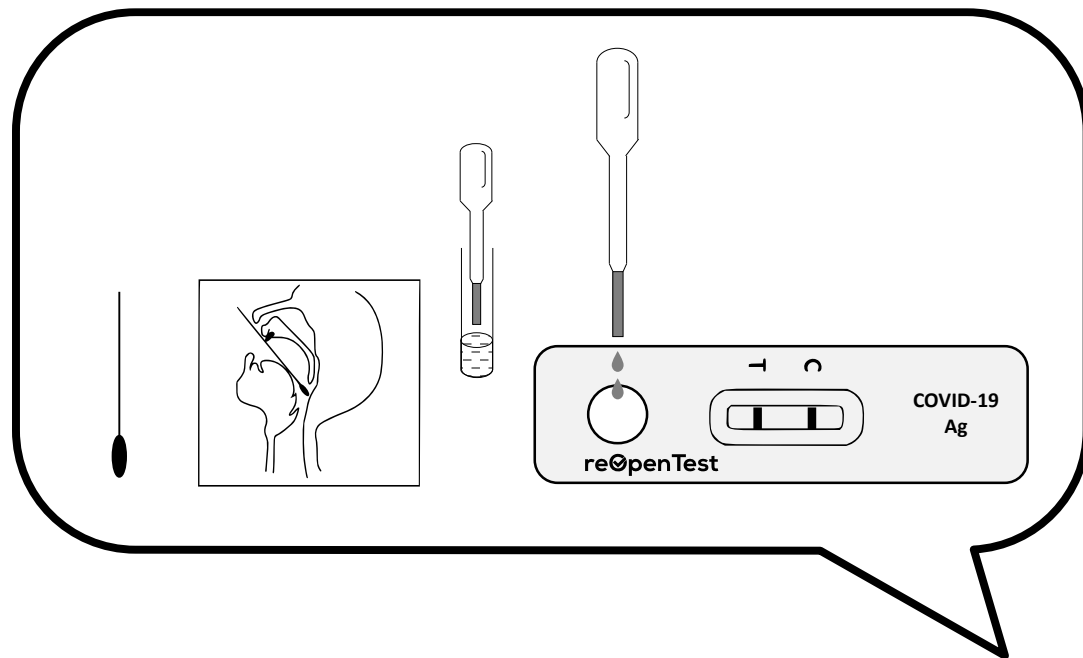

Mobile Testing & Tracking

② Get Report

- ✓ 15 minutes View Result
- ✓ Report to CDC

③ reOpen-Passport

- ✓ Red Positive / Green Negative
- ✓ Encrypted Data Stored Offline
- ✓ Easy to Read and Show with Any scanner App or device.

Data Encrypt in *PDF417*.

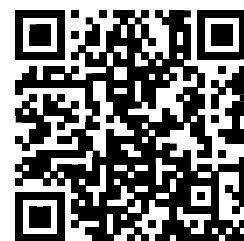

Scan to View Testing Guide

① Easy to Test

- ✓ Follow Guide
- ✓ 3 Step
- ✓ 15 minutes
- ✓ Testing At-Home / Non-labs Settings

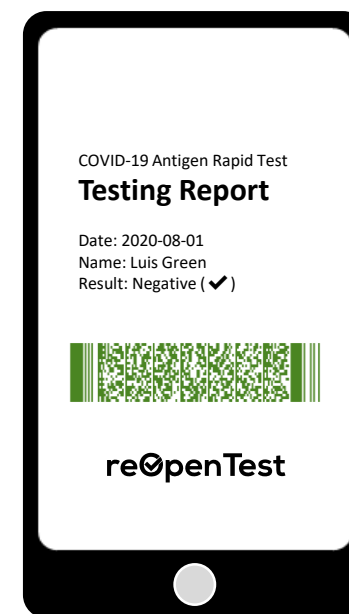
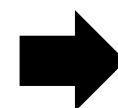
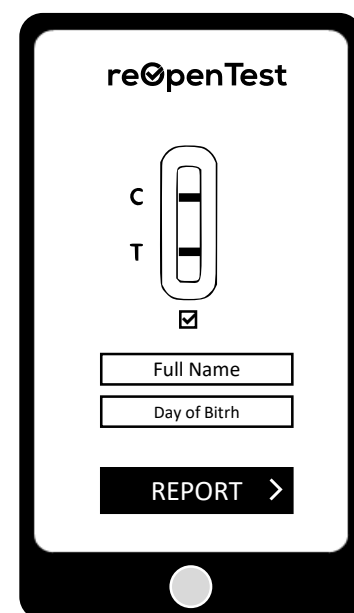

Negative

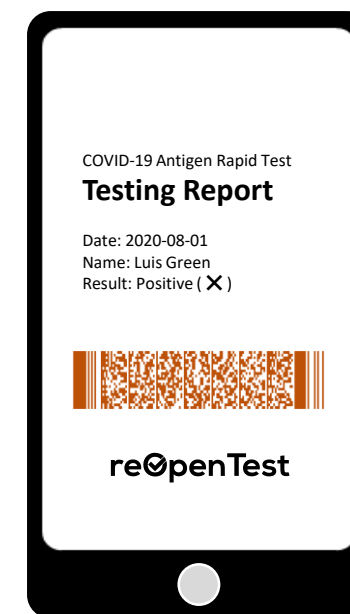

Positive





Global Representative Office Contact

- Rep. & Available to sell
- Available to sell
- Looking for exclusive

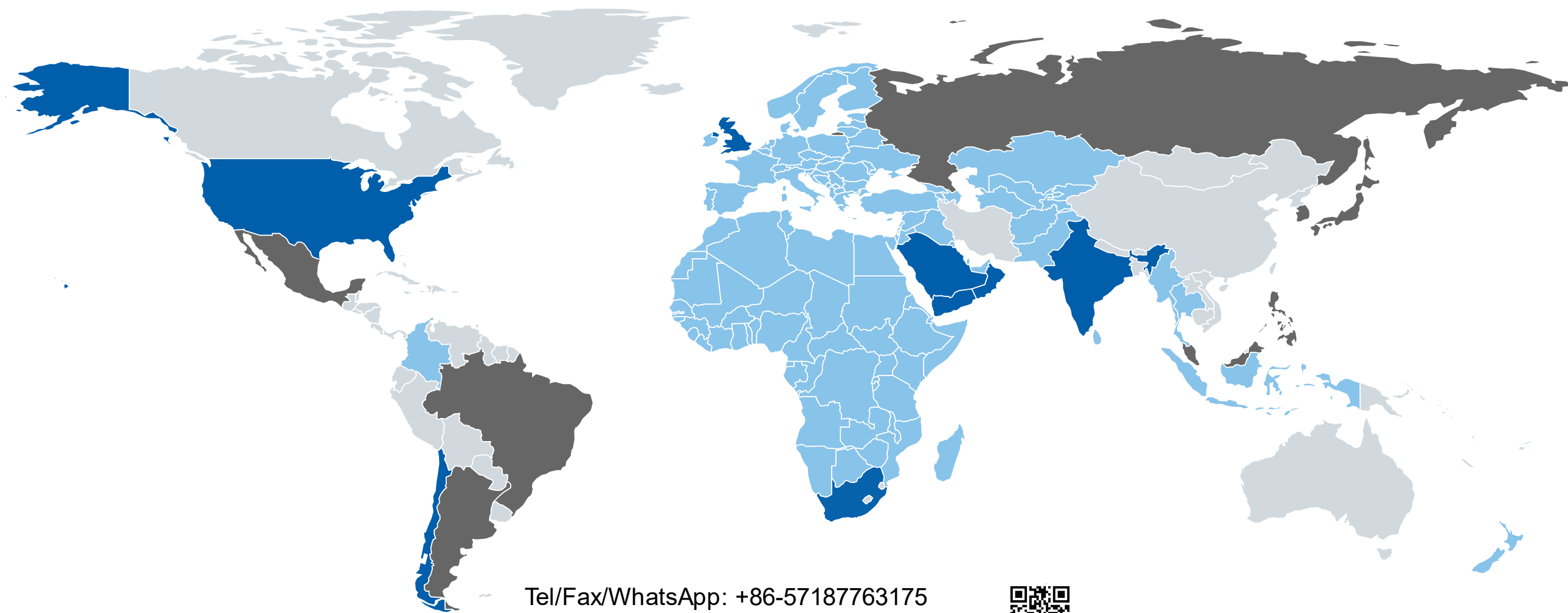

Tel/Fax/WhatsApp: +86-57187763175
Web: www.reopentest.com

